

PINE RIDGE



**KICK
OFF!**



**TOURNAMENT
FWSA 1989
Fairfax, VA**



Good Luck!

To

All Participants
of the

**1989 FWSA PINE RIDGE
KICKOFF TOURNAMENT**

from

McCABE'S MINUTEMAN PRESS

2830 DORR AVENUE • FAIRFAX, VA • 22031

560-7755

W E L C O M E

PINE RIDGE KICK-OFF SOCCER TOURNAMENT

and

DEDICATION CEREMONY



Welcome to the Opening Day festivities at the Pine Ridge athletic field complex. The development of this complex has been a unique cooperative venture, combining the efforts and resources of the Fairfax Women's Soccer Association (FWSA), the Annandale National Little League (ANLL), the Northern Virginia Soccer League (NVSL), the Fairfax County Board of Supervisors, the Fairfax County Park Authority Board, the Fairfax County Park Authority, the Fairfax County Department of Public Works, the Fairfax County Department of Recreation and Community Services, the U.S. Naval Reserve 23rd Mobile Construction Battalion (the famed Seabees), and local businesses.

In 1980, an interim use agreement gave 36 acres of the unused Pine Ridge High School site to the Fairfax County Park Authority for development into recreational facilities. No funds were designated for the project, so three non-profit organizations (FWSA, ANLL, and NVSL) joined forces and formed the Pine Ridge Association for Little League and Soccer (PALS) to coordinate the development of three Little League and three soccer fields at the site. When it was decided that the entranceway then in use was unsafe for the traffic anticipated with team sports activities, PALS was in danger of losing the potential for developing the site, but the Fairfax County Park Authority stepped in at that time to provide a safe entranceway, making it possible for development of the site to proceed. PALS enlisted the support of the Seabees in grading the site and arranged for additional donations of services and equipment from local businesses. With raffles and various fundraising activities, PALS raised some \$50,000 for the project and also arranged for the donation of approximately \$300,000 worth of in-kind services. In addition, members of PALS have donated many hours of personal manual labor to the project. Despite this effort it appeared that drought, vandalism and poor drainage might spell the demise of the project until the County agencies stepped in with more help. Now with fencing, an irrigation system and an improved parking lot, the Pine Ridge site offers some of the finest ballfields in the County.

Elsewhere in this program we pay tribute to all the organizations, agencies, businesses and individuals who provided support for this project. Through working together and maintaining a positive attitude we have achieved our goal, and we are very proud of this accomplishment. Thank you for joining us in our celebration of the new Pine Ridge Fields.



Dedication Ceremony
Lee Pfaff Field
and
Ruth T. Walton Field
in
PINE RIDGE PARK

Fairfax County Park Authority
Saturday, October 14, 1989

OPENING MUSIC
March Militaire Band

WELCOME
Thomas B. White, Jr., Chairman
Fairfax County Park Authority

INVOCATION
Reverend John Chadsey
Pastor, Dranesville United Methodist Church

PRESENTATION OF COLORS
Lake Braddock High School Varsity Drill Team
March Militaire Band

INTRODUCTION OF DISTINGUISHED GUESTS
Thomas M. Davis, III, Mason District
Fairfax County Board of Supervisors

REMARKS
Thomas M. Davis, III, Mason District
Fairfax County Board of Supervisors

Audrey Moore, Chairman
Fairfax County Park Authority

Sharon Bulova, Annandale District
Fairfax County Board of Supervisors

Katherine K. Hanley, Providence District
Fairfax County Board of Supervisors

DRILL TEAM REVIEW
Lake Braddock High School Varsity Drill Team

REMARKS
Shelly Chapple, Head Commissioner
Fairfax Women's Soccer Association

Clint Alley
Former Board Member, Annandale National Little League

Tim O'Donoghue, President
Northern Virginia Soccer League



PRESENTATION OF RESOLUTIONS

REMARKS

Ruth T. Walton
Lee Pfaff

RIBBON CUTTING

SIGN UNVEILINGS

MUSIC

March Militaire Band

DRILL TEAM REVIEW

Lake Braddock High School Varsity Drill Team

REFRESHMENTS

GAMES

Little League Exhibition Game
Soccer Tournament Game

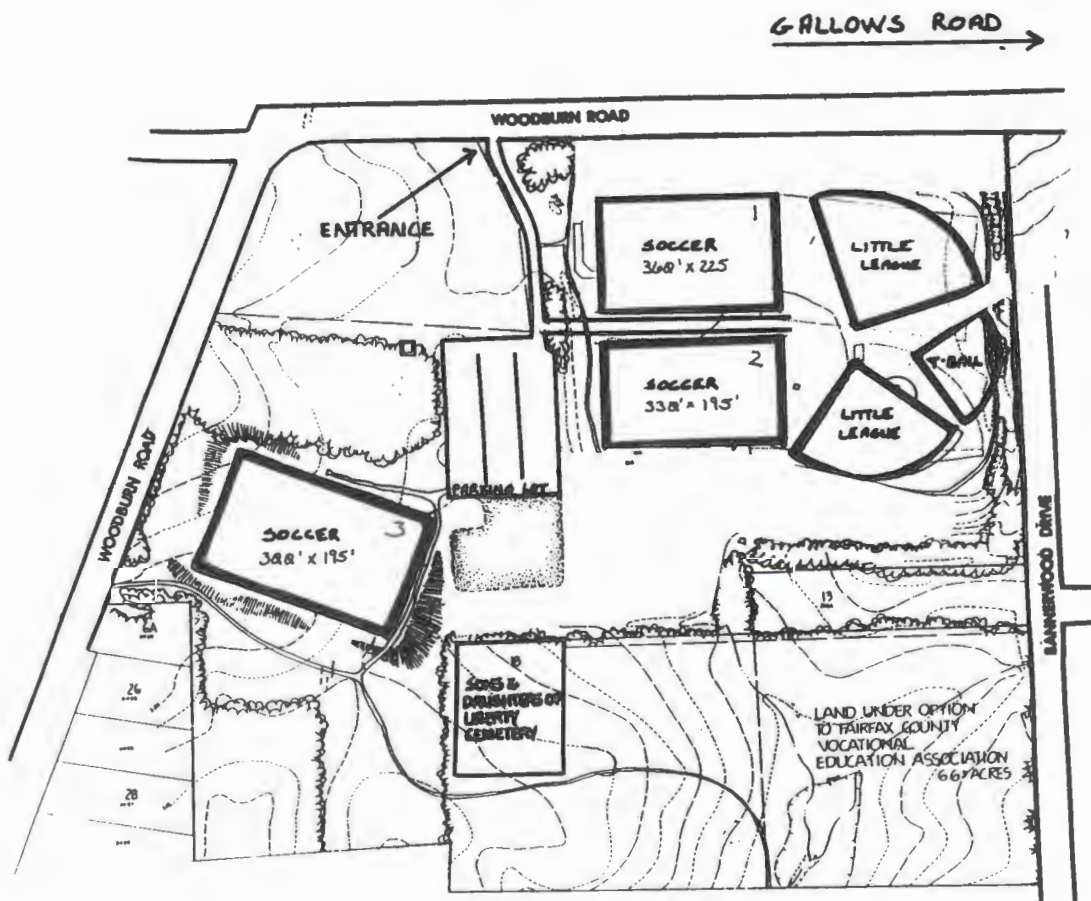

THE FWSA TOURNAMENT MESSAGE BOARD!

We're excited to be playing in
the 1989 Kick-Off Tournament at
Pine Ridge with our FWSA friends.

HAPPY TIMES, SAFE GAMES!

Phoenix B

THANK YOU RUTH WALTON
FOR MAKING A DREAM A
REALITY

THE ZEPHYR

Good Luck to Dennis & Sharon
& the Forthcoming Twins!
Hope to Have You on the
Fields by Spring Season!

- Herndon Herricanes

Get Better Soon, Pam.
FURY Misses You!

Ginny, Debbie, Elaine, Ann,
Jytte, Gwyn, Katie, Laura, Mary,
Melody, Carolyn, Sandy, Karen

Thanks Ruth, Virginia,
the entire Tournament Committee,
& All the Volunteers that Made
the Tournament Possible!

- Shelly



THANK YOU
SEABEES

- PALS



1989 FWSA PINE RIDGE KICKOFF TOURNAMENT



DIVISION I

>>>> PARTICIPATING TEAMS <<<<

| <u>name</u> | <u>color(s)</u> |
|-------------|-----------------|
| Tide | gray/black |
| Omni | teal |
| Pheonix | burgundy |
| Sidekicks | lt blue/white |
| Breakaways | red |

>>>> SCHEDULE OF GAMES <<<<

Saturday

| | | |
|-------|--------------------------------|--------------|
| 7:45 | Tide v Omni | GLASGOW SIDE |
| 9:00 | Pheonix v Sidekicks | GLASGOW BACK |
| 10:15 | Breakaways v Tide | GLASGOW BACK |
| 11:30 | Omni v Pheonix | GLASGOW SIDE |
| 12:45 | Sidekicks v Breakaways | GLASGOW SIDE |
| 2:00 | PINE RIDGE DEDICATION CEREMONY | |
| 3:00 | Pheonix v Tide | PINE RIDGE 3 |
| 4:15 | Sidekicks v Omni | PINE RIDGE 3 |

Sunday

| | | |
|-------|----------------------|--------------|
| 7:45 | Breakaways v Pheonix | PINE RIDGE 1 |
| 9:00 | Tide v Sidekicks | PINE RIDGE 1 |
| 10:15 | ----- | |
| 11:30 | ----- | |
| 12:45 | Omni v Breakaways | PINE RIDGE 3 |
| 2:00 | ----- | |
| 3:15 | FINAL DIVISION I | PINE RIDGE 1 |
| 4:30 | ----- | |

Night & Day Interstate Lights The Way

We carry a wide variety of electrical supplies and lighting to suit your tastes & needs.
With expert assistance on the lighting layout of your home or business.

*Commercial * Industrial * Residential * Institutional*

interstate

Lighting & Electric Supply

Baltimore, MD-(301)944-6700
FAX (301)944-6908
Chantilly, VA-(703)378-5900
FAX (703)378-3557
Charlottesville, VA-(804)977-1010
FAX (804)977-4022
Fairfax, VA-(703)560-2500
FAX (703)560-1059
Frederick, MD-(301)663-0800
FAX (301)662-3465

Fredericksburg, VA-(703)896-9100
FAX (703)898-8014
Hagerstown, MD-(301)791-1300
FAX (301)733-2562
Lynchburg, VA-(804)528-4343
FAX (804)846-0776

Manassas, VA-(703)368-2500
FAX (703)368-9034
Roanoke, VA-(703)982-2500
FAX (703)982-2567
Rockville, MD-(301)762-8100
FAX (301)762-5029
Washington, DC-(202)
FAX (202)628-0782
Woodbridge, VA-(703)494-4444
FAX (703)494-2922

**One-Stop Shopping
For All Your Soccer Needs**



2744-G Gallows Road, Vienna, VA
703/280-5540

M-F 8:30-6:00/Wed. 8:30-8:00/Sat. 9:00-5:00
Visa & MasterCards Welcome



Directions: From Beltway to Exit 7W to 1st light at Gallows Road towards Merrifield thru 3 lights past Lee Hwy. 1/2 mile on left. 1/4 mile Dunn Loring Metro stop

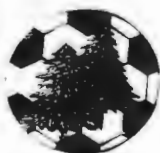

1989 FWSA PINE RIDGE KICKOFF TOURNAMENT



DIVISION II

>>>> PARTICIPATING TEAMS <<<<

| <u>name</u> | <u>color(s)</u> |
|--------------------|-----------------|
| Herndon Herricanes | white |
| Zephyr | red |
| Goal Diggers | navy/white |
| Shaboom | pink/black |
| Fury | green/white |

>>>> SCHEDULE OF GAMES <<<<

Saturday

| | | |
|-------|--------------------------------|--------------|
| 7:45 | Herndo Herricanes v Zephyr | PINE RIDGE 3 |
| 9:00 | Goal Diggers v Shaboom | PINE RIDGE 1 |
| 10:15 | Fury v Herndon Herricanes | PINE RIDGE 3 |
| 11:30 | Zephyr v Goal Diggers | PINE RIDGE 3 |
| 12:45 | Shaboom v Fury | PINE RIDGE 1 |
| 2:00 | PINE RIDGE DEDICATION CEREMONY | |
| 3:00 | Goal Diggers v Herndon H'canes | GLASGOW SIDE |
| 4:15 | Shaboom v Zephyr | GLASGOW SIDE |

Sunday

| | | |
|-------|------------------------------|--------------|
| 7:45 | Fury v Goal Diggers | PINE RIDGE 3 |
| 9:00 | Herndon Herricanes v Shaboom | PINE RIDGE 3 |
| 10:15 | ----- | |
| 11:30 | ----- | |
| 12:45 | Zephyr v Fury | PINE RIDGE 1 |
| 2:00 | ----- | |
| 3:15 | FINAL DIVISION II | PINE RIDGE 3 |
| 4:30 | ----- | |



Soccer Academy

School of Soccer Excellence

Winning is to Learn



- ★ Team Sessions
- ★ Soccer Camps
- ★ Coaching Clinics

John Ellis, Director

For Information Call:
703-631-0037

MANY THANKS!



STAR SUPPLY CO., INC
T/A JIM DEAVER'S HARDWARE

7326 LITTLE RIVER TPKE.
ANNANDALE, VA 22003

JIM DEAVER
PRESIDENT
703-256-2050



Fairfax Womens Soccer Association

Soccer Academy is a proud sponsor of Pine Ridge Park. We were privileged to have provided the expertise and time to ensure the new soccer fields were marked out.

PIZZA MOVERS

642-2424



**PIZZA MOVERS Delivers
TASTE - FAST & FREE**

Rated #1 by Washingtonian Magazine

7320 Little River Turnpike
Annandale, VA 22003

ASK ABOUT OUR BUSINESS LUNCH SPECIALS



INTERIOR DECORATING A CAREER OPPORTUNITY

*Do You have a talent for decorating?
Would you like to have your own
business but don't know how to get started?*

**If you qualify for a Decorating Den
franchise, you will benefit from:**

- A successful and proven business formula
 - On-going training taught by professionals
 - National advertising and recognition
 - Quality products and sources
- Best of all, you are not alone!*

*Call now for reservations
to learn more about **Decorating Den**
the franchise family to grow with!*

**Metro 569-0898
Local 1-800-476-2666**

Decorating Den.

1989 FWSA PINE RIDGE KICKOFF TOURNAMENT



DIVISION III

>>>> PARTICIPATING TEAMS <<<<

| <u>name</u> | <u>color(s)</u> |
|--------------|-----------------|
| Kicks | green |
| Shady Ladies | lt. blue |
| Babes | red |
| Alphas | burgundy/white |
| Wild Fire | red |

>>>> SCHEDULE OF GAMES <<<<

Saturday

| | | |
|-------|--------------------------------|--------------|
| 7:45 | Kicks v Shady Ladies | GLASGOW BACK |
| 9:00 | Babes v Alphas | GLASGOW SIDE |
| 10:15 | Wild Fire v Kicks | GLASGOW SIDE |
| 11:30 | Shady Ladies v Babes | GLASGOW BACK |
| 12:45 | Alphas v Wild Fire | GLASGOW BACK |
| 2:00 | PINE RIDGE DEDICATION CEREMONY | |
| 3:00 | Babes v Kicks | PINE RIDGE 1 |
| 4:15 | Alphas v Shady Ladies | PINE RIDGE 1 |

Sunday

| | | |
|-------|--------------------------|--------------|
| 7:45 | ----- | |
| 9:00 | ----- | |
| 10:15 | Wild Fire v Babes | PINE RIDGE 1 |
| 10:15 | Kicks v Alphas | PINE RIDGE 3 |
| 11:30 | ----- | |
| 12:45 | ----- | |
| 2:00 | Shady Ladies v Wild Fire | PINE RIDGE 1 |
| 3:15 | ----- | |
| 4:30 | FINAL DIVISION III | PINE RIDGE 1 |

Visit the Merchants of Stonewall Square Shopping Center

At the corner of Lee Highway & Cedar Lane

Your Neighborhood Stores!

Flowers for All Occasions
Delivery Service Available

Commercial-Residential
Wire Service

The Master's Touch Creations

FLORISTS AND GIFTS

STONEWALL SQUARE SHOPPING CENTER

8630J LEE HIGHWAY
FAIRFAX, VIRGINIA 22031
(703) 573-2861

GWANA'S HAIR SALON

8630 F LEE HIGHWAY
FAIRFAX, VA. 22031

641-8866



The name says it all:

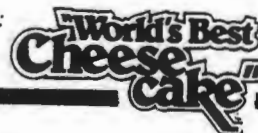

World's Best Cheesecake, Inc.
8636 Lee Highway
Fairfax, VA 22031
(703) 560-9400

See the newest fashion rage from...
THE MASTER'S TOUCH CREATIONS
"The Creating Place"

"Nails to Go"™

Personally designed for the busy woman
by SONDRA LEA

STONEWALL SQUARE SHOPPING CENTER
8630J LEE HIGHWAY
FAIRFAX, VIRGINIA 22031
(703) 573-2861

1989 FWSA PINE RIDGE KICKOFF TOURNAMENT



DIVISION IV

>>>> PARTICIPATING TEAMS <<<<

| <u>name</u> | <u>color(s)</u> |
|----------------|-----------------|
| Astros II | red/white |
| F.C. Astros | red |
| Goal Shakers | yellow/black |
| Goal Rush | blue/white |
| Redshins | red |
| Virginia Kicks | red/white |

>>>> SCHEDULE OF GAMES <<<<

Saturday

| | | |
|-------|--------------------------------|--------------|
| 7:45 | Virginia Kicks v F.C. Astros | PINE RIDGE 1 |
| 9:00 | Goal Shakers v Goal Rush | PINE RIDGE 3 |
| 10:15 | Redshins v Astros II | PINE RIDGE 1 |
| 11:30 | Virginia Kicks v Goal Shakers | PINE RIDGE 1 |
| 12:45 | F.C. Astros v Redshins | PINE RIDGE 3 |
| 2:00 | PINE RIDGE DEDICATION CEREMONY | |
| 3:00 | Goal Rush v Astros II | GLASGOW BACK |
| 4:15 | ----- | |

Sunday

| | | |
|-------|----------------------------|--------------|
| 7:45 | ----- | |
| 9:00 | ----- | |
| 10:15 | ----- | |
| 11:30 | Goal Shakers v Redshins | PINE RIDGE 1 |
| 11:30 | Astros II v Virginia Kicks | PINE RIDGE 3 |
| 12:45 | ----- | |
| 2:00 | FC Astros v Goal Rush | PINE RIDGE 1 |
| 3:15 | ----- | |
| 4:30 | FINAL DIVISION IV | PINE RIDGE 3 |

T H A N K Y O U

The Pine Ridge Association for Little League and Soccer (PALS) wishes to thank all the people who have made this athletic field complex possible.

First of all, we want to thank each other (the member organizations) - Fairfax Women's Soccer Association, Annandale National Little League and Northern Virginia Soccer League - for working together and for persisting when the going got tough. Thanks for digging rocks, removing boulders and debris, putting up silt fencing, pounding stakes through straw bales, spreading mulch, serving lunch to the Seabees, selling raffle tickets, mowing, watering, hand seeding, raking, etc., etc., etc.

Secondly, we want to thank all the County leaders and County agencies who have been so incredibly responsive and supportive throughout this joint project. It would be impossible after 9 years to identify all the ways in which they have helped, but without their counsel and advice, not to mention budget support, this project would have failed years ago:

The Board of Supervisors
Fairfax County Park Authority Board
Fairfax County Park Authority
Fairfax County Department of Public Works, Division of Solid Waste
Fairfax County Department of Recreation and Community Services
Fairfax County School Board
Fairfax House

Three individuals who have served this project well above "the call of duty" just have to be mentioned here: Jay Jorgensen and Buck Whetsell from the Park Authority and Bobby Smith from the Division of Solid Waste. We can't say enough good things about the support and counsel they have provided.

Our mutually beneficial arrangement with Fairfax House has been particularly unique and rewarding. Residents and Counselors of Fairfax House have provided manual labor in an atmosphere of service and learning and we have been able to provide monetary remuneration ("spending money") for trips and excursions.

Next, we want to thank an organization in a class all by themselves - the U.S. Naval Reserve 23rd Mobile Construction Battalion (the famed Seabees) who provided hundreds of hours of grading at the site and assisted in the placement of a drain and of numerous soil erosion controls over a period of two years plus. This exercise was undertaken by the Seabees as a service to the community and as a training opportunity for the men of this Battalion. We believe it was successful on both counts. One of the main reasons for the success of this participation was EOC Gary Peacock, an outstanding leader and an exceptional individual, who gave many hours above and beyond the required drill hours.



Next, we have all the businesses who responded favorably to our request for donations of in-kind services or goods, or monetary contributions. Listed below and on our Soccer Tournament T-Shirt are the names of those companies whose donation was valued at \$250 or more:



Chantilly Turf Farm
Jim Deaver's Hardware
William A. Hazel Company
Holland Engineering
Masterturf
Mobil Oil
Neff and Neff Sand and Gravel
Quarles Petroleum
Southern States Cooperative
Virginia Ground Covers

One additional contribution in this category was received after the T-Shirts had "gone to press:

Soccer Academy

Additional contributions from local businesses include many "indispensables," such as stakes, seeding, silt fences and refreshments for the Opening Day Ceremonies! Thank you:

Cervantesand Associates
DriggsCo.
Fuddruckers
Giant
Hechinger's
Matt Godek Rugby & Soccer Supply
McDonald's
Sheets Wholesale
Southland Corporation
Stanley-Martin Co.

We also want to express our appreciation to our contractor:

Brickman's

who, in a very limited time frame (April 1989 to October 1989), has helped transform our clumpy, weed-filled soccer fields into the beautiful green turf you see today, and to:

John Ellis, Soccer Academy

who donated the initial, always difficult, lining of the fields.

Last, but not least, we want to call your attention to the advertisers who appear in our program. In most instances their willingness to advertise in the program represents an awareness of civic responsibility as well as marketing, and we appreciate their support of this project.

Whenever possible, please support all of the businesses, agencies, organizations, leaders and individuals who have supported us.

THANK YOU. THANK YOU. THANK YOU. THANK YOU. THANK YOU. THANK YOU.

FREE SKYLINER CHEESE CONEY

with purchase of any "Way"

Valid only at Washington D.C./Virginia area Skyline
Chili restaurants. Not good with other coupons
or offers. Limit one per customer.

YORKTOWNE
DELICATESSEN

573-3877

8114 Arlington Boulevard,
Falls Church, Virginia 22042
In the Yorktown Shopping Center

We Cater Everything
Free Lunch Delivery for Your Office
Owned by Eddie, Sam and Tony Saa

Come Visit the Merchants at Yorktown Center!

(703) 876-1930

MORA'S
HAIR DESIGN
YORKTOWN CENTER

8122 Arlington Blvd.
Falls Church, VA 22042



Book 'N Card
OPEN 7 DAYS A WEEK

8110 ARLINGTON BLVD.
FALLS CHURCH, VA 22042 PHONE: (703) 560-6999

Hours: Monday Thru Friday - 9 to 10
Saturday - 9 to 9
Sunday - 9 to 6



DIVISION I TEAM ROSTERS



Tide

Stephanie Schank
Penny Schulstad
Belinda Crawford
Cherryl Hubbard

Kim Holbrook
Shirley Metzger
Nancy Hoffman
Monica Carra

Barbara Miskimmin
Bonnie Forst
Pat Grogan

Sidekicks

Carol Berlo
Margaret Evans
Nancy Karst
Jane McLure
Tee Thomas
Willie Shabelski

Sylvia Dulany
Pattie Giesecke
Mary Lanman
Karen McPherson
Wanda Toombs
Sue Stanford

Sally Entlich
Pam Godfrey
Cherry Lassiter
Bev Mulcahey
Judy Bennett
Marjie Smoot

Omni

Carol Morris
Sue Niebling
Kathy Klug
Helene Schnoy
Sandy Bryll
Carol McCoskri
Teresa Buschmann

Sherry Barker
Nancy Wood
Mary Kesser
Lori Layman
Sherry Johnson
Mary Lou Soller
Kizzy Witford

Judy English
Lyn Nations
Judy Kutcher
Zena Cook
Teresa Emrico
Nora Gabaldón
Karen Dolan

Breakaways

Suzi Brunelle
P.J. Jorgenson
Barbara Lockhart
Jeanne Markunas
Olga Munoz

Deb Frodigh
Judy Lackey
Susan Lowe
Trish McNaul
Carol Murphy
Midge Williams

Anne Gray
Sharon Lester
Connie Mackey
Jill Moebus
Melinda Patterson

Pheonix B

Gayle Brown
D.J. Fussell
Dory Walter
Karen Cowgill
Nancy Crawford

Linda Hughes
Kathy Wood
Carolyn Barnett
Anne Marie Goss
Arlene Gagnon

Dana Richardson
Barbara Smith
Judy Shapiro
Barbara Young



Indoor Soccer

AT
SPORTS NETWORKS' MAGNIFICENT INDOOR SOCCER ARENA
LIBERIA AVENUE, MANASSAS

• EXCITING, ACTION, EXCELLENT FITNESS •



Sports Network the largest superb indoor arena in the DC Metro area providing perfect playing conditions to play soccer, skillfully and safely.



Sports Network Soccer leagues, for Youth teams, Men, Women & Co-ed. Soccer leagues are for all abilities and age groups.



Sports Network Team practice,—Player Development Program. Plan your practices on a perfect surface. Individual or teams provided with instruction and scrimmage.



Sports Network Tournaments
Join a week-end Soccer Tournament.



Sports Network, Programs for individuals and teams.
Team Parties, air-conditioned, heated.



Sports Network. The Staff with the **expertise and experience** (providing soccer in the only facility built solely for soccer).

INFORMATION: CALL 703-631-0037

Fairfax Women's Soccer Association - PALS

Dear PALS:

We at Sports Network are delighted that your long term hard work has paid off with the opening of the Pine Ridge athletic site. This site will serve as a model and inspiration for other Womens and Mens groups who wish to provide a top class playing facility.

We have enjoyed a number of your teams in the past at Sports Network and look forward to seeing them again this winter.

Good Luck and enjoyable kicking at the new complex.

Sincerely,

Rob Olson

Rob Olson
Manager.

MANY THANKS!



"THE REF'S GONNA CALL
OBSTRUCTION ON YOU"



THE BETTER WAY TO DECORATE

- Custom Window Treatments
- Furniture
- Wallcovering
- Carpet
- Residential & Commercial
- Shop at Home
- Days, Evenings and Weekends
- Free Consultation

Metro 569-0898

Local 1-800-476-2666

Together we can pull it together.

Decorating
Den

DIVISON II TEAM ROSTERS



Fury

Sandy A. Hern
Karen Durand
Debbie Kossow
Gwyneth Radloff
Laura Szwak

Jytte Atkinson
Ginny Grove
Debbie Ludwick
Ann Rice
Melody Vincenzes

Pam Chase
Carolyn Hougan
Mary McCafferty
Katie Roderick
Elaine Way

Herndon Herrricanes

Becky Crisman
Shelly Chapple
Karen Horton
Debbie Reynolds
Annie Ruth

Diane Bird
Judy Fleming
Sherry KuyKendall
Mikki Rutledge
Cathy Schourek

Sallie Burch
Dorothy Hankinson
Brenda Jackson
Marty Rygg
Leslie Tracy

Goal Diggers

Cheryl Allen
Diane Connolly
Pat Howard
Chris Rhatigan
Kate Splendore

Chris Andrews
Michele Dupre
K.D. Lambert
Sharon Rusnak
Mary White

Nancy Cammarata
Mimi Hoffman
Glo Powers
Dianne Miller
Kathy Victor

Zephyr

Dava Burke
Sue Folliard
Shirley Cannon
Betty Casad
Sandy Smith
Ruth Waltman
Jeanne Farris

Carla Jaranson
Lynn Wagner
Sue Pratt
Diana Saine
Carolyn Bryant
Pam Willenz
Penny Long

Linda Cook
Jean Joy
Lynn Schwab
Pat Martin
Sue Williams
Ann Frazier

Shaboom

Donna Ahearn
Nancy Hill
Susie King
Carol Paguette
Candy Sanderson

Laura Carver
Edie Jackson
Dixie McCarter
Dawn Phillips
Una White

Denny Daniel
Judy Jones
Pat McNabb
Margie Reeder
Beth Williams

SOUTHERN STATES FAIRFAX PETROLEUM SERVICE

*Serving Northern VA Area Since 1940
(Route 28 and Route 50)*

Complete Line

"Lubricants"

- Package Sizes
Quarts to
55 gal Drums
- Motor Oils
- Grease
- Hydraulic Oil
- Transmission Fluid
- Anti Freeze

"Tanks"

- Fuel & Water
55 gal Pickup to
30,000 gal UST.
Installation Available

**Use Our
Green and
save yours**



**Southern States
SUPER GREEN
Diesel Fuel**

"Fuels"

- Gasoline Unleaded
 - 93 Octane
 - 89 Octane
 - 87 Octane
- Reg. Available
limited deliveries
 - Premium #2
 - Fuel Oil
 - K-1 Kerosene

"Pumps"

- Quart Stroke up to
50 GPM
 - 12 Volt
 - Electric
 - Meters Available

Please Call "Bob Murray"
Petroleum Marketing Representative

703-378-8516 or 378-4865

361-8300 or 631-5211

P.O. Box 409 14401 Penrose Place
Chantilly, VA 22021

DIVISION III TEAM ROSTERS



Shady Ladies

Sandy Boyles
Lu Ann Molaski
Cindy Chambers
Mary Cate Rush
Teresa Fay
Michelle Lanier

Melissa Milner
Mary Caughlin
Erin Parnigoni
Lisa Dimicco
Martha Golden
Denise Cain

Tami Burns
Laurie McCardle
Mary Beth Compton
Dobby Wall
Maureen Golden

Wildfire

Sharon Haslet
Karen Jennings
Jenni Lind
Melissa Rosen

Jeanne Squier
Barb Layman
Monica McMahon
Laurie Seaton
Cathy Simmons

Debbie Houk
Maureen Leahy
Alicia McGreevey
Suzanne Schmidt

Kicks

Cathy Beck
Caryn Cossarek
Debbie Holland
Patti Maguire
Linda Schoenecker

Susan Rogers
Carolyn Holland
Debbie Wathen
Debbie Arndt
Cindy Stilwill
Diane Brody

Cindy Beck
Bridget Leahey
Wanda Rixon
Carol Schumacher
Maggie Massie

Alphas

Brenda Potosnak
Diana Herndon
Retta Teeters
Barb Keen
Laurrin Etko Shepherd

Sydney Shepherd
Carolyn Lisbon
Therese Burrus
Cindi Cisek
Julie Behms

Cathy Crampton
Lisa Moses
Gail Stelman
Kathy McMenamir

Babes

Sandy Woods
Dana Wiley
Joanne Carter
Leslie Sprague
Kate Patterson

Ann Coleman
Michelle Straution
Lynn Craft
Judi Whitestone
Brenda Meek

Heidi Hess
Laura Ralston
Ann Bryaes
Pat Ryan
Kim Willingham

FORBES VIDEO

"thousands of movies to rent"

560-5645

Merrifield Plaza

607 South Ball St. • Arlington, Virginia 22202

MERRIFIELD **1 HR** PHOTO

- FAST QUALITY SERVICE
- INSTANT PASSPORT PHOTOS
- PHOTO BUSINESS CARDS
- PHOTO GREETING CARDS
- VIDEO PRODUCTION

(703) 560-3845

MERRIFIELD PLAZA SHOPPING CENTER
2831 GALLOWES ROAD
FALLS CHURCH, VA 22042



MON.-FRI. 9:00-7:00 pm
SAT. 10:00-7:00 pm
SUN. 12:00-5:00 pm

Drop by and Visit Merrifield's Merchants!

Win or Lose, One Thing's the Same:



There's nothing like a Big Mac® sandwich after the Big Game!

McDonald's of
Gallows Road

GOOD TIME.
GREAT TASTE.

KEITH'S TV SERVICE

573-1300

2853 Gallows Rd.
Falls Church, VA 22042

The Mail Box Center

- Private Post Box Leasing
- Ship U.P.S.
- Federal Express
- Photo Copy
- Packing Supplies
- Office Supplies
- Fax To Fax
- Keys Made
- Business Card
- Rubber Stamp



Tel. & Fax (703) 560-1938

MERRIFIELD PLAZA SHOPPING CENTER
2831 GALLOWES ROAD
(Lee Highway and Gallows Road)
FALLS CHURCH, VA 22042



DIVISION IV TEAM ROSTERS



Redshins

Felicia Ambrose
Stacey Altemus
D.J. Fleagle
Andrea Mattingoy
Vickie O'Donoghue

Carolyn Willis
Dawn Eilenberger
Carol Murphy
Janet Thuxford
Nancy Martino
Tammy Lenox

Betsey Carey
Linda Thompson
Shiela Jones
Sheri Person
Kate Riepe

Goal Rush

Tara Schiffert
Mary Spoth
Karen Sharpe
Mary Swain
Ann Frazier

Amanda Coker
Cheryl Emich
Katie Macklin
Julie Kemp
Jennifer Williams

Kathleen Carter
Karen Mosher
Denise Vitet
Dawn Boyce

Virginia Kicks

Colleen O'Day
Carolyn Omeara
Mailie Kalinowski
Julia Leighton
Emily Rothberg
Janet Caswell
Leanne Shalstis

Shirley Higuchi
Anna Goldrich
Kathy Kennedy
Julie Ceighton
Nellie Oberholtzer
Dana Stam
Deirdre Mulligan

Tanya Hileman
Beverly Baird
Christi Fearson
Julie Damon
Kirstan Crane
Sharon McQuarney

Astros II

Linda Arens
Sally Birch
Linda LaGarde
Helen Long
Susie Malcom
Maddy Cargill

Debbie Berg
Chiyoko Hoagland
Kery Shelley
Pam Dankel
Jayne Peck
Laurie Bennett

Stephanie Hughes
Cindy Fritzinger
Eva Bishop
Mary Ann Pizzi
Luann Bloom

Goal Shakers

Michelle Gray
Susan Frederick
Vicki Pyszka
Lisa Williams

Holly Berrett
Denise Frein
Kristin Hoft
Kathy Seymour

Petra Blanchard
Sherry Daisy
Niza Hoft
Sarah Hauserman

F.C. Astros

Karen Army
Maureen Duran
Kelly Higgins
Yvonne Morris
Beth Schehl
Janeen Westphal

Andrea Baines
Jeanne Hellings
Lori Lacava
Meg Romaine
Sue Vodicka
Karen White

Colleen Costello
Ann Hellings
Marie McKeon
Mary Pat Rudenhouse
Becki Weary

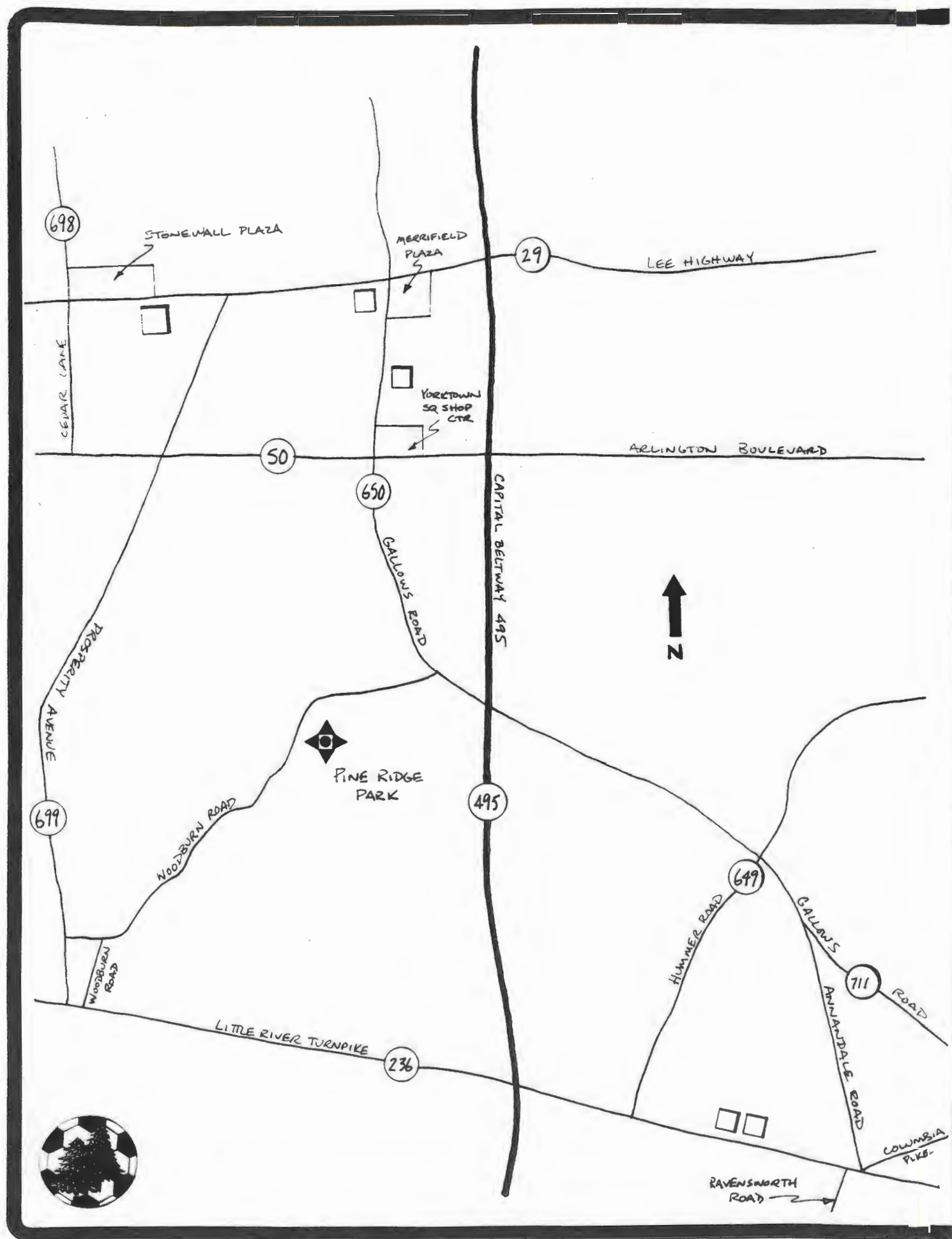

THANK YOU



From all of us who have helped put this tournament together and from all those who are participating in the tournament, we would like to extend a big thank you to the following volunteers who made this tournament possible:

Debbie Arndt

Laura Carver

Shelly Chappel

Virginia De Paris

Jeanne Farris

Sue Folliard

Carla Jaranson

Mary Keeser

Carol Morris

Terri Orie

Kathy Seymour

Penny Shulstad

Cindy Stilwill

Laura Szwak

Lynn Wagner

Ruth Walton

Debbie Wathen

Susan Williams

Awards

Sponsors

Referees

Refreshments

Tarps

T-Shirts

Registration Letter

Confirmation Letter

Program

Field Marshalls

First Aid

First Aid

Communications

Sponsors

T-Shirt Sales

Game Schedule

Rules

Score Boards

Registration

First Aid

Artwork: T-Shirts,
Awards, & Program

Sponsors

Sponsors

Registration Ltr

Sponsors

Ceremony

Program

Refreshments

Don's Johns

Sponsors

EUROPE

SUPERFARES

Via Major Scheduled Carriers At Charter Prices

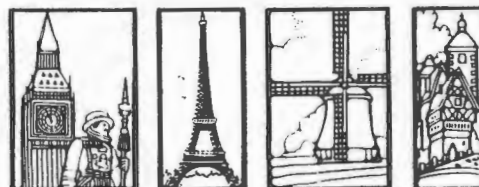

Destinations

US Originations Only

1 October 1989-
31 March 1990 **

| | AMSTERDAM | COPENHAGEN | FRANKFURT | GLASGOW | LONDON | PARIS |
|----------------|--|--|--|--|--|--|
| | \$345 from via Baltimore, Boston New York, Washington | \$435 from via Baltimore, Boston New York, Washington | \$295 from via Baltimore, Boston New York, Washington | \$345 from via Norfolk | \$310 from via Baltimore, Boston New York, Washington | \$355 from via Baltimore, Boston New York, Washington |
| ATLANTA | 425 | 530 | 425 | 435 | 375 | 450* |
| BALTIMORE | 345 | 435 | 295 | 365 | 310 | 355* |
| BOSTON | 345 | 435 | 295 | 365 | 310 | 355* |
| CHICAGO | 375 | 470 | 375 | 415 | 355 | 390* |
| CINCINNATI | 425 | 530 | 425 | 435 | 375 | 450* |
| CLEVELAND | 425 | 530 | 425 | 435 | 375 | 450* |
| COLUMBUS | 425 | 530 | 425 | 435 | 375 | 450* |
| DALLAS | 425 | 530 | 425 | 435 | 375 | 450* |
| DENVER | 425 | 530 | 425 | 435 | 375 | 450* |
| DETROIT | 425 | 530 | 425 | 435 | 355 | 450* |
| HOUSTON | 425 | 530 | 425 | 435 | 375 | 450* |
| INDIANAPOLIS | 425 | 530 | 425 | 435 | 375 | 450* |
| KANSAS CITY | 425 | 530 | 425 | 435 | 375 | 450* |
| LAS VEGAS | 470 | 580 | 505 | 530 | 470 | 450* |
| LOS ANGELES | 470 | 580 | 470 | 530 | 470 | 505* |
| MILWAUKEE | 425 | 530 | 425 | 435 | 375 | 450* |
| NASHVILLE | 425 | 530 | 425 | 435 | 375 | 450* |
| NEW YORK | 345 | 435 | 295 | 365 | 310 | 355* |
| NORFOLK | 355 | 450 | 310 | 345 | 285 | 365* |
| ORLANDO | 425 | 530 | 425 | 435 | 375 | 450* |
| SALT LAKE CITY | 470 | 580 | 505 | 530 | 470 | 505* |
| SAN FRANCISCO | 470 | 580 | 470 | 530 | 470 | 505* |
| ST. LOUIS | 425 | 530 | 425 | 435 | 375 | 450* |
| TAMPA | 425 | 530 | 425 | 435 | 375 | 450* |
| WASHINGTON | 345 | 435 | 295 | 365 | 310 | 355* |

**Surcharge for October 1-31 of \$75 MW and \$95 WK

*Surcharge from 15 Mar-31 Mar 1990 may apply

- Infants (under 2 years) \$99 roundtrip • Tax \$23
- Saturday night minimum stay • Oneway=half plus \$50
- Reservations can only be made as follows:
Outbound: Within 45 days of departure date.
Return: Within 90 days of departure date.
- Flight numbers/times advised upon confirmation.
- Mix and match flights available. Fly into one city.
Return from another.
- All fares plus \$8 Eastbound and \$15 Westbound
for U.S. departure tax. Federal inspection fees and
airline security charge. (\$23 roundtrip)

All prices per person. Children discounts not available. Infants pay \$50 one way, \$99 roundtrip, plus taxes, when not occupying a seat otherwise full fare. All reservations confirmed immediately, if available, within the time frames specified below. It is advisable to ask your clients for alternative dates before calling for reservations.

- All tickets issued upon receipt of payment.
- Only full payment guarantees fare.
- NOPTAS.
- Use half of each fare when mixing seasons.
- No European originations.
- No open ventures.
- No compulsory insurance required.
- Regular airline services apply.
- 2 day advance purchase.

- No un-accompanied minors.
- Cancellations/changes, once confirmed:
Prior to departure: \$25 per person if not ticketed.
50% penalty per person once ticketed. After
departure: No changes allowed. No refunds for
no-shows.
- Late booking fee: \$25 per person within 5 days
of departure.
- Strongly recommend trip cancellation insurance

All fares subject to availability and change without notice

Travel Wholesalers International (TWI)-hereinafter referred to as the Tour Operator, acts only as agent for the airlines and other suppliers of services and accommodations. As such, the sole financial responsibility of the Tour Operator is limited to, the amount of commission it receives from the said suppliers and airlines in arranging services on behalf of the passengers.

If any supplier shall cancel the specified services for insolvency, the Tour Operator is bound to refund all deposits received on behalf of the named Client upon advice and/or refund from said Supplier. This program is subject to any and all terms, and conditions under which any services are provided by the Suppliers. The Tour Operator shall not become liable for any personal injury, property damage, accident, delay, inconvenience, change in itinerary or accommodations, or other irregularity which may occur due to (1) wrongful neglect, or arbitrary acts or omissions on the part of the Suppliers, their employees or others not under the direct control of the Tour Operator, (2) defects or failures of any conveyance, equipment, or instrumentality under the control of the Suppliers, and (3) but not limited to Acts of God, fire, acts of governmental or other authorities, wars, civil disturbances, riots, strikes, thefts, pilferage, epidemics, quarantines, or dangers of incident to the sea, land, and air.

Baileys X Roads
998-7330

Fair Oaks Mall
385-1122

OMEGA WORLD TRAVEL
Flights Provided By TWI



"BUT NANCY SAID THE FIELD
WAS PLAYABLE?!"